

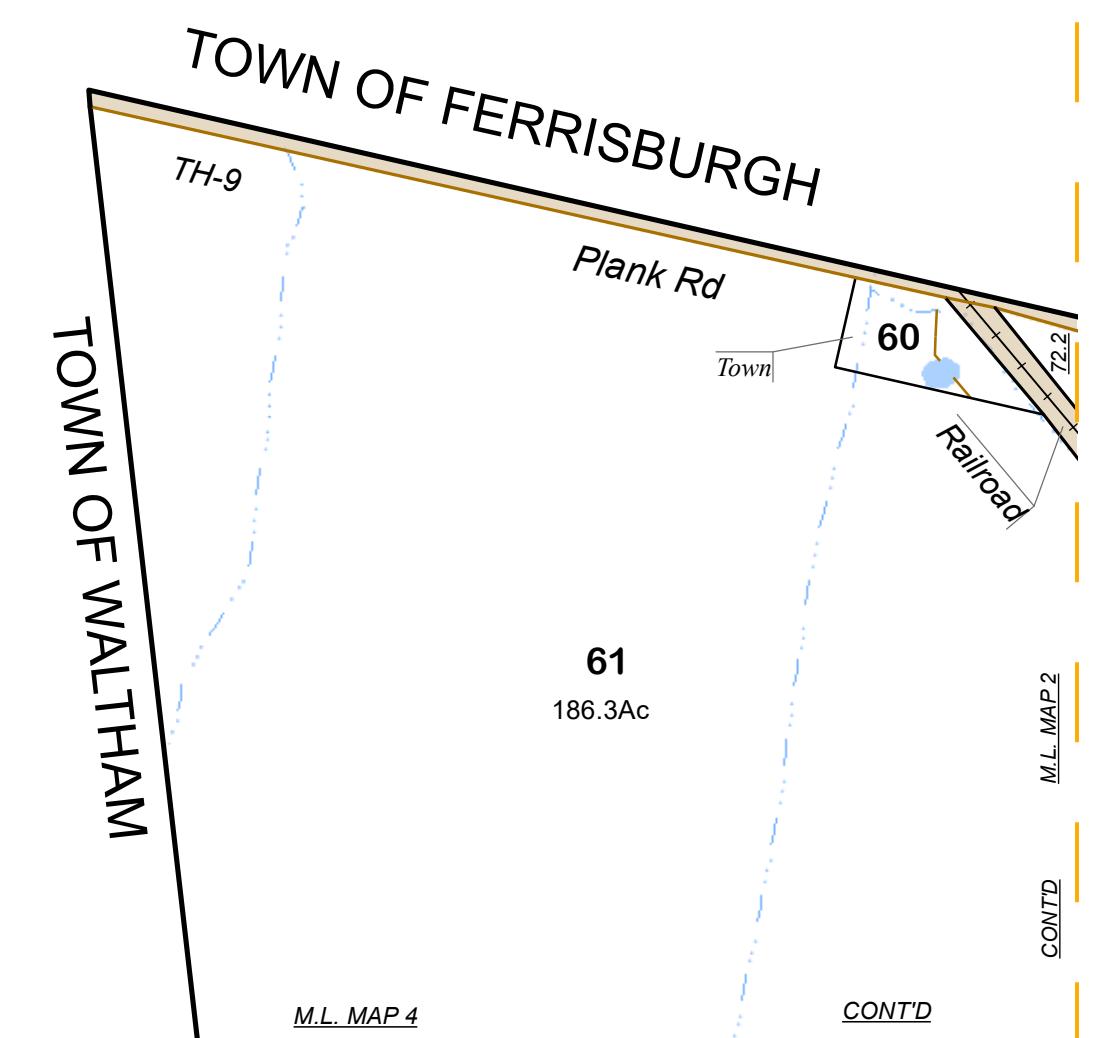

Index

MAPID
0060.000
0061.000
0072.200

NAME
TOWN OF NEW HAVEN
ALLANDRA FARM INC.
PAINTING JR JOSEPH



THIS MAP IS FOR ASSESSMENT PURPOSES ONLY. IT IS NOT TO BE USED FOR DESCRIPTION, CONVEYANCE, OR DETERMINATION OF LEGAL TITLE. ALL INFORMATION IS SUBJECT TO CHANGE.

ORIGINAL BASE MAP WAS PREPARED BY BRUNO ASSOCIATES, WOODSTOCK, VT.

UPDATED BY
CHRISTINE CHAMBERLAIN
MAPPING

UPDATED THROUGH APRIL 1, 2022

- LEGEND**
- Town Boundary
 - Parcel Boundary
 - Road
 - Subparcel
 - Unlanded
 - Railroad
 - Parcel Not Matched in Grand List
 - Right-of-Way
 - Parcel Hook
 - Surface water
 - Utility Easement
 - Match Line

- 123** Parcel Number
- (123) Historical Parcel Number
- (22.1Ac) Subparcel Acreage
- (1) Lot Number
- 453000 State Plane Coordinate (m)
- AcS Survey
- AcC Calculated

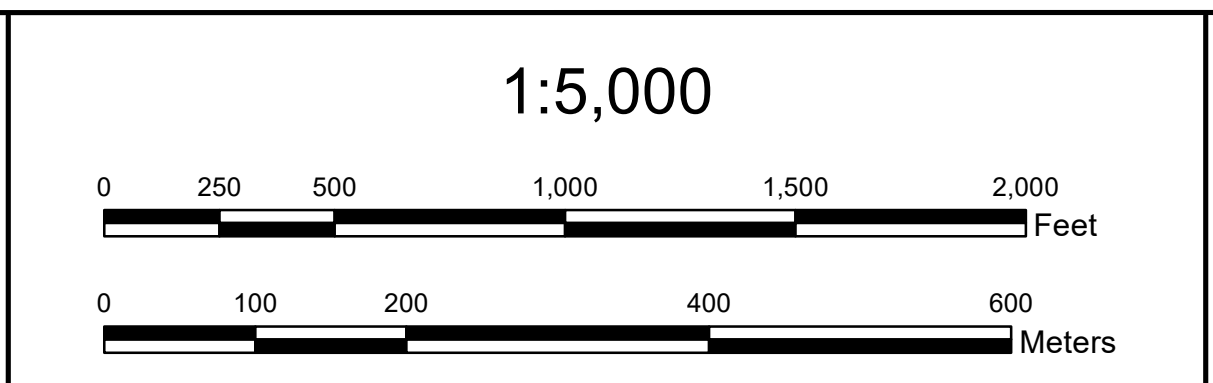

TOWN OF
NEW HAVEN
VERMONT

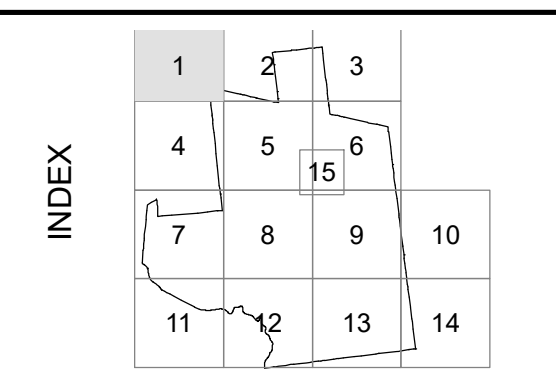

LOCAL MAP NO.
1
VERGENNES EAST
STATE MAP NO. 092184