

Contacts

Selectboard

Kathy Barrett: 453-4232

Roger Boise: 453-2682

Carole Hall: 453-5543

Charlie Roy: 453-3054

Doug Tolles: 545-2020

Town Clerk

Pam Kingman: 453-3516

Town Treasurer

Barb Torian: 453-3516

Town Shed

453-3397

Beeman Elementary

453-2331

Mt. Abe High School

453-2333

Superintendent's Office

453-3657

Community Library

Deborah Lundbech: 453-4015

Events Coordinator

Suzy Roorda: 453-5978

Fire Chief

Alan Mayer: 453-5129

377-0475 (cell)

Burn Permit: Fire Warden

Dave Heisler: 453-7286

771-7236 (cell)

Planning Commission

Francie Caccavo: 453-2198

Development Review Board

Tim Bouton: 453-4596

Zoning Administrator

Dave Wetmore: 453-3516

Animal Control Officer

Wayne Marcelle:

1-802-233-9534

Any non-profit group event that is open to all members of the community can be listed in the Community calendar.

Contact:

Pam Kingman: 453-3516

Suzy Roorda: 453-5978

Selectboard Report

By the time you get this newsletter, the primary elections will be over. Check the website www.newhavenvt.com for the results. School will be back in session and life will return to structured routines for many of us. I hope you have all had a great summer.

A concern that we have is the number of applications for net-metered solar farms that are less than 150 kw. At the present time, the Selectboard is aware of five applications for these smaller solar farms and the potential for one or two large scale solar farms within the town. Smaller solar farms are not required to go through the public hearing process that larger scale solar farms are required to go through. While our zoning by-laws do not address solar farms, they do have specific setbacks for structures which should be adhered to. The front yard setback from the center line of the road ranges between 75 feet to 200 feet, depending on the zoning district and the side yard setback can be up to 100 feet. We would like to see some kind of screening to limit the visibility of the solar panels from the road and from the neighbors. We respect a landowner's right to develop their property and we ask that you respect the rights of your neighbors.

Steve Dupoise came to the Selectboard to continue the "Can Mobile" at the Town Shed, where you can leave your redeemable bottles and cans. The original purpose was to raise funds to cover the cost of finishing the baseball field. With that goal achieved, the proceeds now support the Beeman sports program.

Respectfully submitted, Kathy Barrett, Selectboard Chair

Library News

Welcome to those early fall days, with the smell of apples in the air, and the crickets going wild in the grasses! It was a beautiful summer, and great to see so many of you stopping in to pick up summertime reads, audio books, and movies. Congratulations to all the summer program readers. At press time, I don't have a final count of books read yet, but I know there were a lot! Thank you to the Friends for funding the gift books to all the summer program readers. They are always so appreciated.

Many thanks also to the Friends of the New Haven Community Library for buying the library a new iPad Air tablet. It has been very popular here; and I'm sure its popularity will continue to grow as more people discover how easy and fun it is to use.

The first Friends meeting of the year will take place off-site on Wednesday, September 3rd, at 7pm. The Friends would love to have you join them! It would be great to see this wonderfully supportive organization welcoming in more members. Please call me at the library for more information.

Game Night will be held on the fourth Wednesday from now on, starting September 24th at 6:30. The Trustees and I have been exploring a new online library system with many potential advantages. If they decide to move forward on this, I will describe it more fully in the October newsletter.

Deborah Lundbech, Town Librarian

Tax Bills

Tax Bills were mailed on July 9, 2014. Please contact the Town offices if you have not received your bill. Please see the August newsletter for payment details.

The next time the town will receive property tax adjustment information from the State is on Sept. 15th. We will mail corrected bills as soon as we get new or changed information from the State.

Barb Torian, Treasurer

Chicken and Biscuit Dinner

New Haven Congregational Church
Sunday, Sept. 7th
Two sittings: noon and 1pm

Adults \$9, children 6-12 \$4.50, and under 6 free

Reservations appreciated; Call Brenda, 453-3498
Walk-ins welcome. Takeout available.

Attention Local Farmers & Food Producers!

The New Haven Farm and Food Festival will be held October 12th at the Lester Farm on Rte 7 from 12:00 - 3:00 PM. This is an opportunity for all of our town's food producers to showcase and sell their products.

Last year's festival was an overwhelming success with several hundred attendees. Large or small, if you grow meat, fruit, vegetables, cheese, flowers, herbs, or make syrup, honey, canned goods, or any farm and garden produce, join your fellow New Haven farmers and exhibit at this year's festival!

Admission is FREE. In addition to the farm market and food tasting, there will be games, music, wagon rides, and a petting zoo. Best of all (for a small ticket price), there will be a pig roast, barbecue, and buffet featuring all locally-produced food.

Mark your calendar to attend this family event!
Come support and celebrate the farming tradition in New Haven.

For exhibiting information or details about the festival, contact Maura Lester (453-3193) or Suzy Roorda (453-5978).



Where was it? Hunt Road

Correct Answers: Nobody. Extra credit this month if you can narrow it down, now that you know which road it is on. :) 

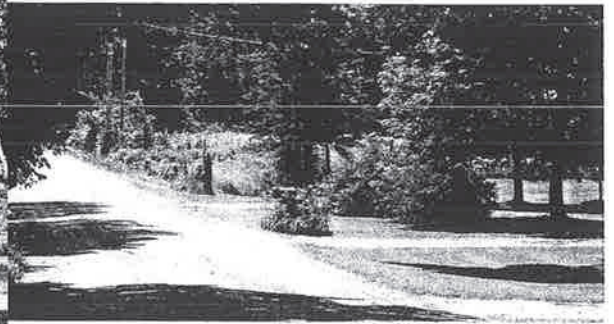

Where is it? E-mail your answers to me at jgallott@gmavt.net, write the answer down and drop it off at the Town office or hand it to me if you see me around town. Deadline September 15.

September 2014 New Haven Community Calendar

Location of Events Key: TH Town Offices= TO Town Garage= TG Cafeteria= C Gym= G Beeman= S MAUHS= HS Village Green =VG Village Green Market= VGM Congregational Church= CH Library= L Fire Station= FS * Recycling at Town Garage Saturday Mornings 8-12 *

Sun	Mon	Tue	Wed	Thu	Fri	Sat
New Haven Cub Scouts! Call James Bachand to Join! 349-3830	1 Labor Day Town Office Closed	2 Selectboard Mtg. 7pm TO	3 Fire Dept. Mtg. 7pm FD Friends of the Library Meeting off-site 7pm Please call 453-4015 for info.	4 ZUMBA Exercise Class 6pm-7pm G Library Teen Group 7pm L	5 Bone Builders Exercise Class 10:30am CH	6 Recycle 8am-12pm TG
7 Grandparent's Day! Chicken & Buscuit Dinner 12pm & 1pm \$9Adult/\$4.50 Kids Call- 453-3498	8 Planning Commission Meeting 7pm TO	9 Full Moon Library Story Hour 10:30am L	10 Town Office Closed for Educational Purposes Historical Society 7pm L 4H Twilight Tails 6:30pm Call 453-5219 for location.	11 Patriot Day ZUMBA Exercise Class 6pm-7pm G Energy Meeting 7pm L	12 Bone Builders Exercise Class 10:30am CH	13 Recycle 8am-12pm TG
14	15 DRB Mtg. 7pm TO	16 Selectboard Mtg. 7pm TO Library Story Hour 10:30am L	17 Library Teen Group 7pm L Ladies Union Mtg 7pm CH	18 ZUMBA Exercise Class 6pm-7pm G Conservation Commission 7pm TO Library Trustee Mtg. 7pm L	19 Bone Builders Exercise Class 10:30am CH	20 Recycle 8am-12pm TG
21	22	23 Autumnal Equinox Library Story Hour 10:30am L Tai Chi for Arthritis Part 2 1pm at CH—545-2106 For info.	24 Library Game Night 6:30pm	25 Rosh Hashanah ZUMBA Exercise Class 6pm-7pm G Tai Chi Part 2 at 1pm at CH 545-2106 For info.	26 Bone Builders Exercise Class 10:30am CH	27 Recycle 8am-12pm TG
28	29	30 Library Story Hour 10:30am Tai Chi for Arthritis Part 2 1pm at CH	*If your town group or club would like its meetings or events listed in the Town Newsletter Calendar, please contact Suzy at 453-5978, 453-3516 ext. #17,			
	Rent the Town Hall for your own events or parties, or to teach classes. Please submit your application at least 3 weeks prior to your event	to allow the Selectboard time to review and process the application. Applications available at the Town Office or on the Town's web site.			Bone Builders has moved to the Congregational Church on Town Hill Road. Fridays at 10:30am.	To register in any Town group or club, please call one of the phone numbers listed below. Thanks~

Contacts: Fire Dept. 453-3654 * Town Shed 453-3397 * Beeman 453-2331 * MAUHS 453-2333 * ANESU 453-3657 * Energy Coor 453-4752 * Ladies Union 877-3080 * Library 453-4015 * Karate 453-2405 * Equine 4H 453-5219 * Dairy 4H 545-2484 * Cub Scouts 349-3830 * Boy Scouts 453-2128 * Girl Scouts 453-4735 * Soccer 545-2742 * Little League 453-2724 * Historical Soc. 989-4066 * * Crime Watch 453-5978 & Police 388-4919 * Mary Johnson Children's Center 388-4304 * Swing Dance 475-2349 * Bone Builders 453-5978 * Tai Chi-545-2106 * ZUMBA 758-2482

Town of New Haven
78 North Street
New Haven, VT 05472
453-3516

PRSR STD
US Postage Paid
New Haven Vermont
Permit No. 1

Postal Patron
New Haven, VT 05472

www.newhavenvt.com

Recycling Saturday mornings 8-12 at Town Garage. Trash drop-off at same time for a fee.

Town Office Hours:

Monday 9:00 am – 4:30 pm
Tuesday 9:00 am – 4:30 pm
Wednesday 9:00 am – 4:30 pm
Thursday 9:00 am – 4:30 pm
Town Offices will be closed
on Monday, September 1, 2014
For Labor Day.

Library Hours

Tuesday 10:00 - 5:00
(10:30 Story Hour)
Wednesday 1:00 - 8:00
Thursday 1:00 - 8:00
Saturday 10:00 - 1:00

Selectboard Report - Page 1

Library News - Page 1

Tax Bills - Page 2

Chicken & Biscuit Dinner - Page 2

NH Farm & Food Festival - Page 2

Where Is It? - Page 2

Community Calendar - Page 3

Tai Chi for Arthritis, Part 2 - Page 4

The newsletter is an open forum for town residents with reports & articles about New Haven & discussions of town matters. Articles of 500 words or less should be courteous & concern town events, news, & issues. One article per month. Please include your name, address, & phone number. (Only your name will be published.) Submit in electronic form by the 15th of the month to jmsimmons@gmavt.net Jean Simmons

Tai Chi for Arthritis, Part 2, will begin September 23rd at 1:00 at the Congregational Church, and will continue on Tuesdays and Thursdays (except holidays) until maybe Christmas—depending on how long it takes to learn! The class is sponsored by CVAA and is free to anyone age 50 or older WHO HAS COMPLETED TAI CHI FOR ARTHRITIS PART ONE! For more information, contact Mary Pratt at 545-2106.